

Edge of Arlington Saw & Tool, Inc.

124 South Collins
Arlington, TX 76010
Phone: 817-461-7171 • Fax: 817-795-6651
Toll Free: 888-461-7171
Email: info@eoasaw.com
Website: www.eoasaw.com

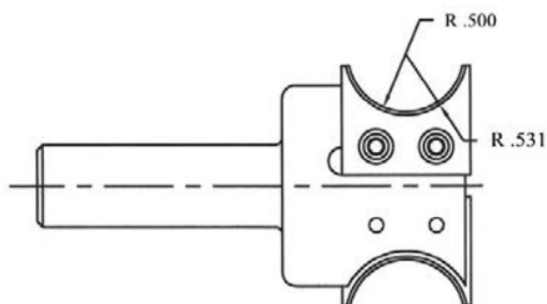

Body #8240 for material
thickness of 1" - 1 1/16"

Item #Kit 8240-INS-8241, Vortex Series 8200 Multi-Profile Bull Nose Insert Body: 8240 BODY W/ INS-8241 INSERTS

\$492.11

Thank you for shopping with us!

Series 8200 Multi-Profile insert cutters are designed to perfectly bull nose the material, providing superior cut quality only precision insert tooling can provide. Two multi-profile tool bodies are available from stock and will accept multiple different radii inserts to fit your needs.



INS-8241-KIT

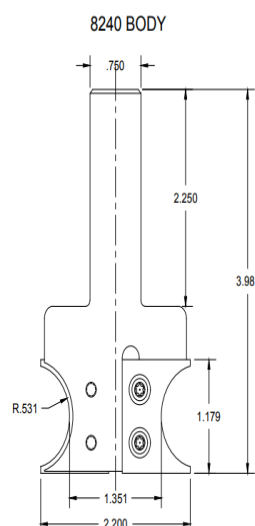

INS-8241



SPECIFICATIONS

Manufacturer	Vortex Tool
Material Thickness	1 in thru 1 1/16 in
Shank	3/4 in
Part Descp.	Insert Body 8240 w/ Insert INS-8241 Insert