

## Edge of Arlington Saw & Tool, Inc.

124 South Collins  
Arlington, TX 76010  
Phone: 817-461-7171 • Fax: 817-795-6651  
Toll Free: 888-461-7171  
Email: [info@eoasaw.com](mailto:info@eoasaw.com)  
Website: [www.eoasaw.com](http://www.eoasaw.com)

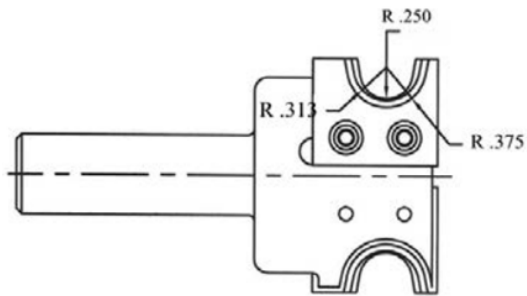

Body 8230 for material  
thickness of 1/2" to 3/4"

### Item #Kit 8230-INS-8230, Vortex Series 8200 Multi-Profile Bull Nose Insert Body: 8230 BODY W/ INS-8230 INSERTS \$492.11

Thank you for shopping with us!

Series 8200 Multi-Profile insert cutters are designed to perfectly bull nose the material, providing superior cut quality only precision insert tooling can provide. Two multi-profile tool bodies are available from stock and will accept multiple different radii inserts to fit your needs.



.

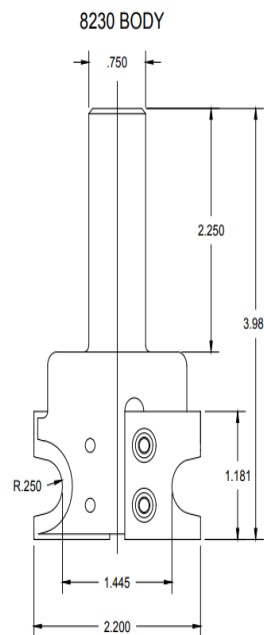

INS-8230

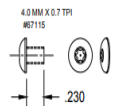

INS-8230-KIT

## SPECIFICATIONS

Manufacturer	Vortex Tool
Material Thickness	1/2 in thru 3/4 in
Shank	3/4 in
Part Descp.	Insert Body 8230 w/ Insert INS-8230 Insert