

Edge of Arlington Saw & Tool, Inc.

124 South Collins

Arlington, TX 76010

Phone: 817-461-7171 • Fax: 817-795-6651

Toll Free: 888-461-7171

Email: info@eoasaw.com

Website: www.eoasaw.com

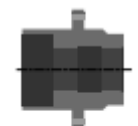

1TL115-35
1TL115-40

Item #1TL115-35, FS Tool Industrial Quality Hogging Units W/Disposable Knives: Sleeve-Standard Production \$303.56

Edge of Arlington offers free shipping in the United States when you choose flat rate shipping **Design:**

- High tensile strength steel body with solid carbide reversible inserts.
- Inserts have 4 cutting edges with chip breaker.
- Hogger set consists of elements that can be three different diameters (234mm, 242mm, and 250mm). This allows for different profile solutions as per drawing examples.
- Chipping width available from 19.2mm and wider, in increments of 15mm.

Application:

- For chip-free sizing of panel materials on double-end tenoners and trimming machines

SPECIFICATIONS	
Diameter	115 mm
Bore	35 mm
Length	92 mm
Manufacturer	FS Tool
Specs-Misc	Keyway 10x4mm (one)